

Whitehall Condominium

2420 Beacon Street
Brighton, MA 02467

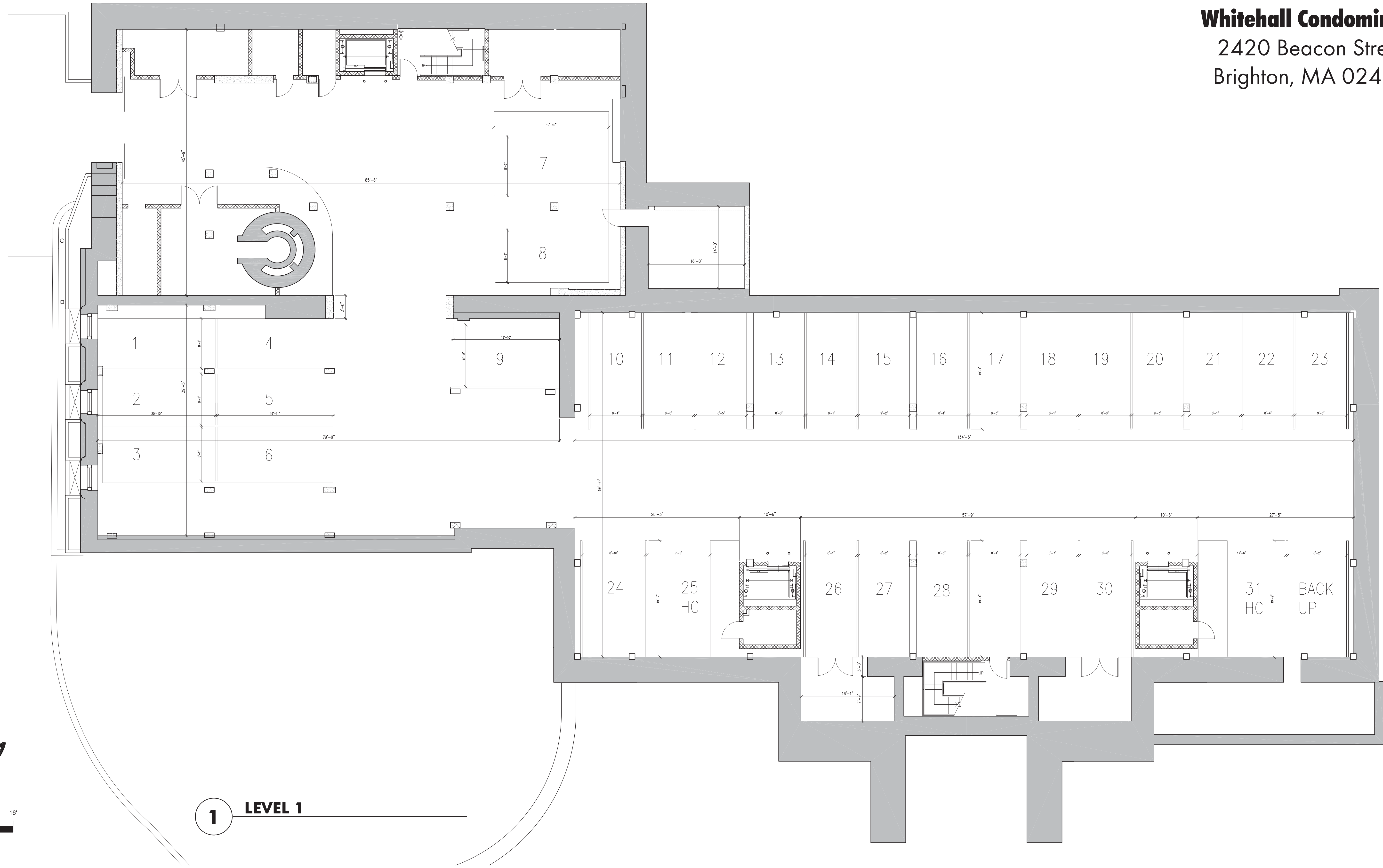

0 4' 8' 16'
SCALE: 1/8" = 1'-0"

1 LEVEL 1

I, GRAHAM GUND, FAIA, AN ARCHITECT REGISTERED IN THE COMMONWEALTH OF MASSACHUSETTS, DO HERBY CERTIFY THAT THIS MASTER PLAN SHEET SHOWING THE WHITEHALL BUILDING IN THE CITY OF BRIGHTON, SUFFOLK COUNTY, MASSACHUSETTS, DEPICTS THE LAYOUT OF THE BUILDING AND THE UNITS, UNIT NUMBERS, UNIT LOCATION, APPROXIMATE DIMENSIONS AND MAIN ENTRANCES AND THE PUBLIC WAY TO WHICH THE UNITS HAVE ACCESS, AS-BUILT AS OF NOVEMBER 29, 2006, I ALSO CERTIFY THAT THE PLAN WAS PREPARED IN ACCORDANCE WITH THE RULES AND REGULATIONS OF THE REGISTRY OF DEEDS.

GUNDPARTNERSHIP
Graham Gund, FAIA
Registered Architect # 3720
November 29, 2006

TABLE OF APPROXIMATE UNIT AREAS

UNIT 101 : 2010 S.F. TOTAL	UNIT 303 : 1883 S.F. TOTAL
UNIT 102 : 1883 S.F. TOTAL	UNIT 304 : 1831 S.F. TOTAL
UNIT 201 : 2044 S.F. TOTAL	UNIT 401 : 1895 S.F. TOTAL
UNIT 202 : 2118 S.F. TOTAL	UNIT 402 : 1900 S.F. TOTAL
UNIT 203 : 2647 S.F. TOTAL	UNIT PH 1 : 2094 S.F. TOTAL
UNIT 204 : 1100 S.F. TOTAL	UNIT PH 2 : 2083 S.F. TOTAL
UNIT 205 : 1093 S.F. TOTAL	UNIT PH 3 : 1957 S.F. TOTAL
UNIT 206 : 2346 S.F. TOTAL	UNIT PH 4 : 2329 S.F. TOTAL
UNIT 301 : 2243 S.F. TOTAL	UNIT PH 5 : 1884 S.F. TOTAL
UNIT 302 : 1895 S.F. TOTAL	UNIT PH 6 : 1730 S.F. TOTAL

FOR REGISTRY USE ONLY

Drawing Key:

- Line of Limit of Ownership: - - - - -
- Common Area:
- Unit Entrance:
- Exterior Limited Common Element Area:

prepared by:
GUND PARTNERSHIP
47 THORNDIKE STREET
CAMBRIDGE, MA 02141
(617)250-6800

